

**FIBERGLASS
EXTENSION ARM
OPERATION AND
SAFETY GUIDE**

SLINGCO PART NOS.
ITP10989 (WITHOUT INSULATOR);
ITP10474 (WITH INSULATOR)
ITP14754 (CHAIN BINDER SINGLE
CONDUCTOR); ITP14726 (CHAIN
BINDER DOUBLE CONDUCTOR)
ITP14767 (RATCHET STRAP SINGLE
CONDUCTOR); ITP14771 (RATCHET
STRAP DOUBLE CONDUCTOR)

⚠ ATTENTION

READ and **UNDERSTAND** all of the instructions and safety information in this manual before operating or servicing this tool.

Failure to read and understand these warnings and safe handling instructions could result in severe personal injury or death.

KEEP THIS MANUAL WITH TOOL.

Thank you for using Slingco® products. This manual must be read and understood prior to operating this product. Special attention should be paid to the section '**Safety Information**'.

This manual should be kept available to all operating and maintenance personnel.

Additional or replacement manuals may be obtained at no charge by contacting your local Slingco office.

CONTENTS

| | |
|-------------------------------|-------|
| SAFETY INFORMATION | 3-5 |
| ELECTRICAL RATINGS & WARNINGS | 5 |
| PURPOSE & USE | 5 |
| PRODUCT DESCRIPTION | 6-7 |
| INSTALLATION INSTRUCTIONS | 8-10 |
| PARTS LIST | 11-13 |
| WARNING LABELS | 14-15 |

SAFETY INFORMATION

ATTENTION

DO NOT perform any service or maintenance on this tool other than described in this manual.

Read and follow the operator's manual before using this tool.

This manual should be kept available to all operating and maintenance personnel.

WARNING PINCH POINT HAZARD



- Keep hands away from mechanism.
- Serious injury may occur.

WARNING SAFETY GOGGLES REQUIRED



- **DO NOT** operate without eye protection.
- Serious injury may occur.

WARNING HARD HAT REQUIRED



- **DO NOT** operate without proper head protection.

WARNING GLOVES REQUIRED



- **DO NOT** operate without proper hand protection.

WARNING SUSPENDED LOAD



- Heavy suspended objects can fall. Can cause property damage, severe injury, or even death.
- **DO NOT** stand under Extension Arm.

WARNING ELECTRICAL SHOCK HAZARD



- This tool is rated for 15kV without insulators and 34.5kV with insulators when wireholders are in correct location, which is stated in this manual.
- Proper protective equipment is required when using the Fiberglass Extension Arm.
- Failure to observe this warning could result in severe injury or death.

WARNING



- Fold unused bracket toward pole.

WARNING SAFETY SHOES REQUIRED



- Safety shoes required when using this product.

SAFETY INFORMATION (CONT.)

WORK AREA SAFETY

1. Keep the area around the equipment clean and free of obstruction.
2. Bystanders should stay clear of the work area to ensure safety.

PERSONAL SAFETY

1. Stay alert while using the equipment to prevent serious injury. Do not use under the influence of drugs, alcohol or medications.
2. Do not wear loose hair or clothes that may get caught while the equipment is in operation.
3. Work safely. Ensure firm footing, be properly secured and do not over-extend yourself when operating equipment.

TOOL USE AND CARE

1. **DO NOT** use this tool if there are any abnormalities or damage to any of its components.
2. Inspect the tool before and after every use. Do not use this tool if it is damaged in any way. Ensure that all pins are secure.
3. When having the tool repaired, always use factory Slingco replacement parts. The tool **MUST BE** repaired and serviced by an individual with the proper training and knowledge necessary.
4. The tool described in this manual is meant to be used by a trained professional that follows safe working practices of the industry. If you do not have the proper training and knowledge of working on/around energized utility lines, **DO NOT USE THIS PRODUCT**. This product is by no means a replacement for the proper training required to operate this equipment and will not prevent injury/death if used improperly.

SAFETY INFORMATION (CONT.)

1. Slingco's Fiberglass Extension Arms and any other Slingco parts and accessories listed in this manual are intended for **temporary support** of energized conductors to provide clearance around work areas. Temporary support and use is defined as using this product no longer than 72 hours under clean and dry conditions. Use under any other conditions or for a longer period of time will result in performance loss.

NOTE: If performance of the materials degrades, it could lead to electrical tracking or other possible 'stress' to the product's fit, finish and performance. The electrical tracking could result in a phase-to-phase or phase-to-ground electric arc, damaging equipment and possibly causing injury to anyone in the area.

2. Do not mount any other equipment or products to the Fiberglass Extension Arm other than wire holders and crossarm brackets.
3. The Fiberglass Extension Arm is never to be used in the case of hurt man rescue. The arm is **NOT** rated for human support.
4. Fold unused bracket toward pole (see diagram to the right).

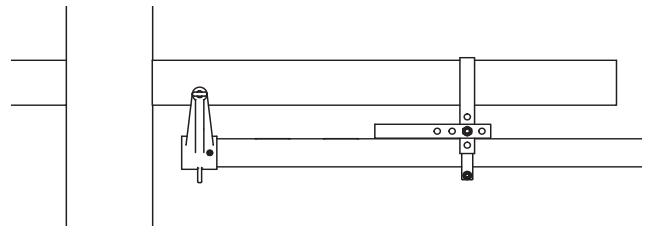

ELECTRICAL RATINGS & WARNINGS

- Extension Arms are rated for 15kV without insulator and 34.5kV with insulator.
- 22" (559 mm) minimum wireholder spacing is required to achieve 15kV phase-to-phase.
- 22" (559 mm) minimum wireholder spacing and Slingco ITP10352 insulators used per wireholder are required to achieve 34.5kV phase-to-phase.
- All metal parts, including wireholders with or without insulators, must be considered energized whenever containing conductors.

PURPOSE & USE

Slingco's Fiberglass Extension Arms are designed to be used in situations such as moving out conductors to create working clearance in congested areas, or as a temporary aid in replacing insulators, and/or replacing existing conductors.

DESCRIPTION

| Part No. | Description | Weight (lb) | Weight (kg) | Phase-to-Phase Rating (as supplied) | Max Vertical Load per Wireholder lb (kg) |
|----------|---------------------------------|-------------|-------------|-------------------------------------|--|
| ITP10989 | Crossarm FEA without Insulators | 21.2 | 9.62 | 15kV | 200 (90.72) |
| ITP10474 | Crossarm FEA with Insulators | 23.4 | 10.61 | 34.5kV | 200 (90.72) |
| ITP14754 | Chain Binder Single Conductor | 16.5 | 7.48 | 34.5kV | 200 (90.72) |
| ITP14726 | Chain Binder Double Conductor | 21.6 | 9.79 | 34.5kV | 200 (90.72) |
| ITP14767 | Ratchet Strap Single Conductor | 14.8 | 6.70 | 34.5kV | 200 (90.72) |
| ITP14771 | Ratchet Strap Double Conductor | 20.0 | 9.08 | 34.5kV | 200 (90.72) |

All Slingco FEAs

- New and clean arms are tested per ASTM F711, OSHA 1910.269(j)(l), and OSHA 1926.957(a)(l).
- Wireholders have a 1.6" (40.6 mm) opening and are rated for 200 lb (90.72 kg) vertical load per wire holder.
- Extension Arms are constructed of 2.5" (63.5 mm) diameter foam-filled fiberglass.

Crossarm mounted FEA

- Furnished with bronze eyebolts
- Supplied with a combination bracket:
 - Small bracket: 3.75" x 4.75" (95.25 x 120.65 mm)
 - Large bracket: 6" x 6" (152.4 x 152.4 mm)

Pole mounted FEA

- All arms include insulators in the wireholders.
- The Slingco Pole Mounted Fiberglass Extension Arm features two triangular cutouts. These cutouts are intended to aid in the installation of the Pole Mounted Fiberglass Extension Arm and are not intended to be used to permanently mount the arm. The ratchet strap or chain binder should be installed and appropriately tensioned before cable can be placed in the wireholders.
- The triangular cutouts can also be used to raise or lower the arm to and from the ground when used in conjunction with a handline assembly.

DESCRIPTION (CONT.)

Recommended wire holder spacing

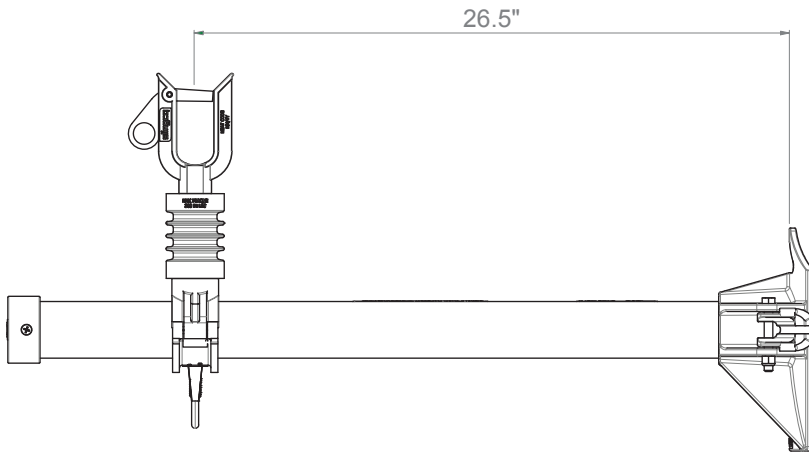

Part No: ITP14754 & ITP14767

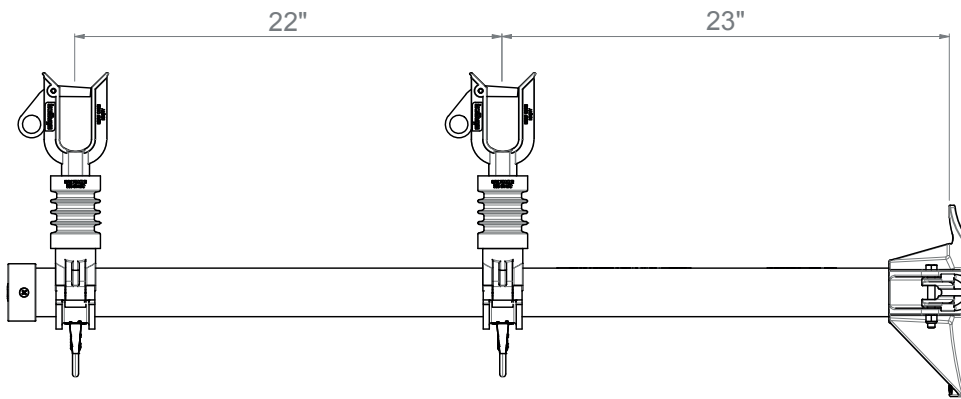

Part No: ITP14726 & ITP14771

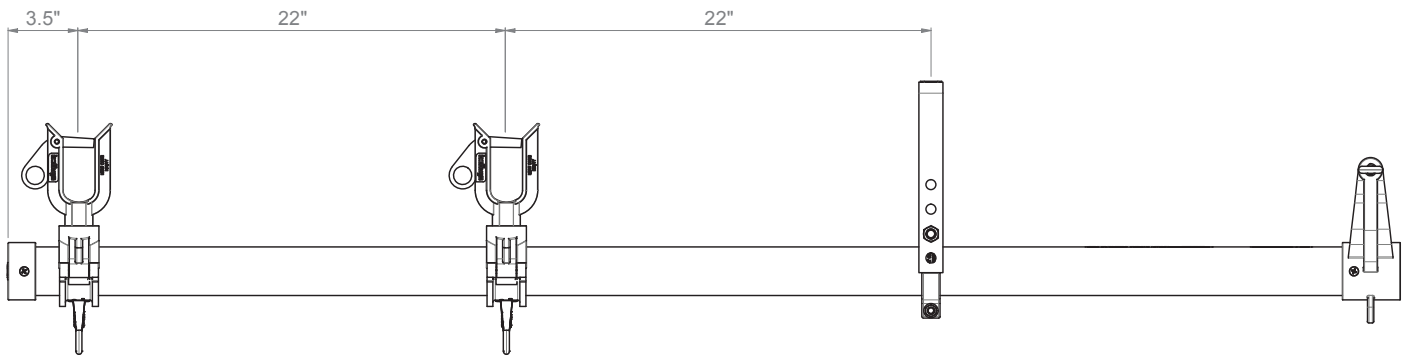

Part No: ITP10989 & ITP10474

Max load per wire holder: 200 lb (90.7 Kg)

INSTALLATION

To install Fiberglass Extension Arm with Chain Binder on pole

1. Loosen the 'Chain Binder Wheel' by rotating it counterclockwise until it contacts the back nut (see Fig. 3).
2. Pull the 'Chain Binder Casting' toward the 'Chain Binder Wheel' until the trigger is locked into the notched section in the 'Spring Loader Rod' (see Fig. 2).
3. Position the Fiberglass Extension Arm on the pole in the desired location and wrap the chain around the pole.

NOTE: When installing, ensure that the triangular cutout on the pole mount casting has the point of the triangles facing toward the top of the pole. (Fig. 1)

4. Pull the chain taught and insert the chain into the retaining socket. Once the chain is securely installed in the socket, install the safety pin through the safety pin holes in the socket that can be found at the end of the chain. (Fig. 1)

5. Depress the trigger mechanism to release the 'Chain Binder Casting' to further tighten the chain.

NOTE: Releasing the trigger mechanism creates pinch points. Keep fingers clear of pinch points. (Fig. 2)

6. Tighten the 'Chain Binder Wheel' by rotating it clockwise until snug. Shake the Fiberglass Extension Arm assembly to ensure that it is properly seated on the pole. Tighten the 'Chain Binder Wheel' until tight. (Fig. 3)

NOTE: If the 'Chain Binder Wheel' has reached the end of its adjustment range before the chain is tight, loosen the wheel and repeat steps 4-6.

7. To remove, reverse the installation procedure.

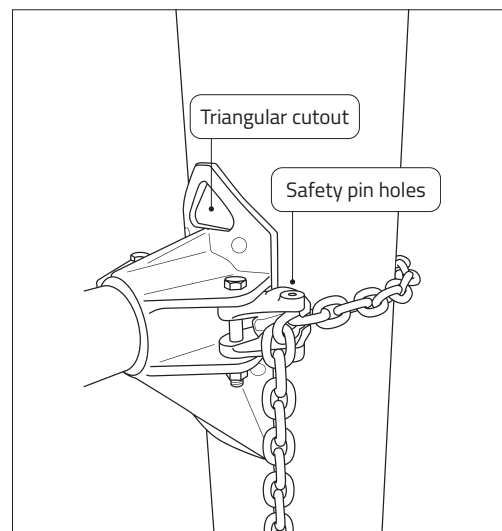

Fig. 1

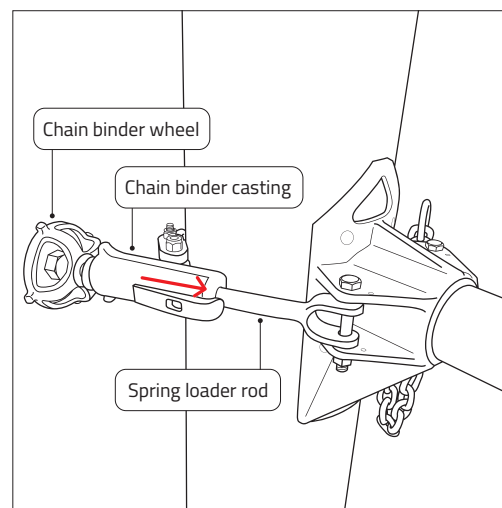

Fig. 2

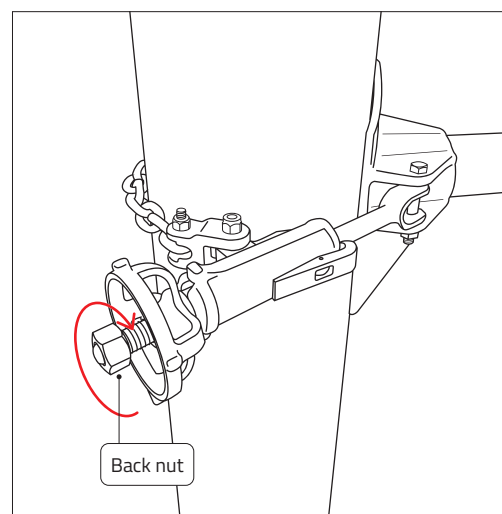

Fig. 3

INSTALLATION (CONT.)

To install Fiberglass Extension Arm with Ratchet Strap on pole

1. Ensure the ratchet strap is in the adjustable position by extending the handle outward to release the tension on the strap (if applicable).
2. With the strapping loose and the handle in the adjustable position, position the Fiberglass Extension Arm on the pole in the desired location and pass the hook end around the pole.

NOTE: When installing, ensure that the triangular cutout on the pole mount casting has the point of the triangles facing toward the top of the pole. (Fig. 1)

3. Attach the hook end of the strap to the pin and pull the excess strapping taught. (Fig. 1)

NOTE: Pay careful attention to ensure the strapping does not twist around the pole. The strapping shall remain flat around the pole and through the ratcheting mechanism.

4. While holding the excess strapping taught, begin tightening the ratchet strap by ratcheting the handle until tight. (Fig. 2)
5. Once tight, close the ratchet strap handle to lock it in place. (Fig. 3)
6. To remove, reverse the installation procedure.

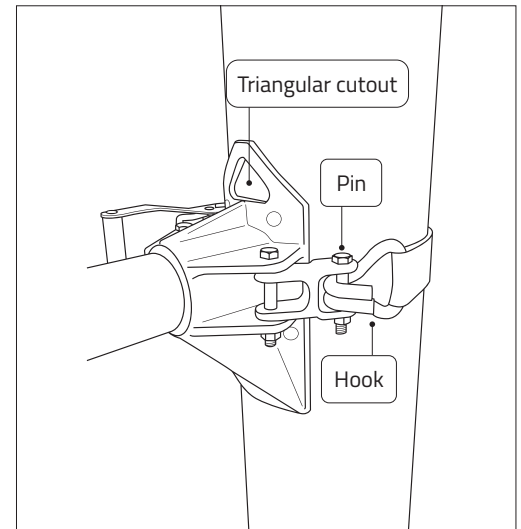

Fig. 1

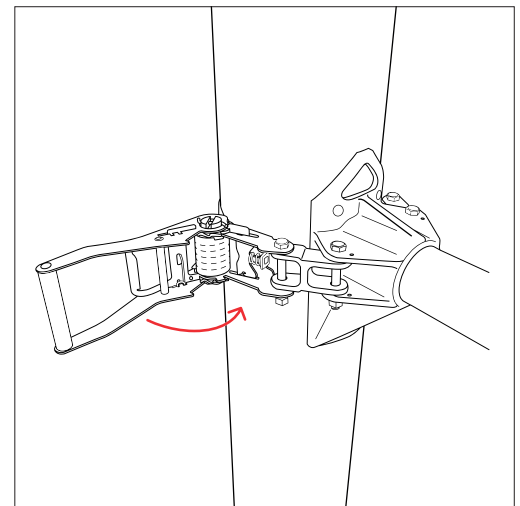

Fig. 2

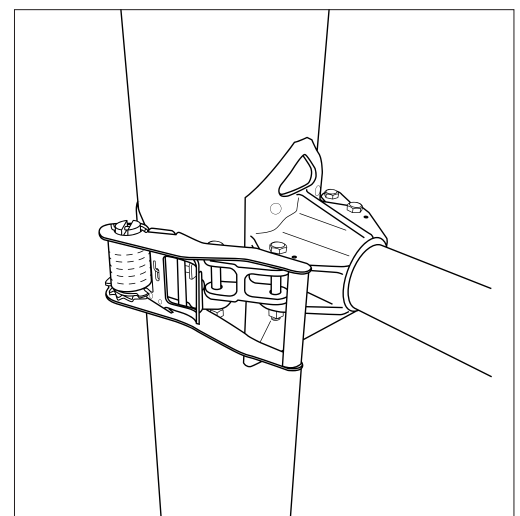

Fig. 3

INSTALLATION (CONT.)

To install Fiberglass Extension Arm with Crossarm Support on pole

1. Slide the Fiberglass Extension Arm down the crossarm until the Crossarm Support Assembly is over the edge of the crossarm. Fits up to 6" x 6" crossarm. (Fig. 1)

NOTE: Ensure the unused bracket is folded toward the pole. See Fig. 1 or diagram on page 5.

2. Tighten the Eye Bolts on each side into the crossarm. (Fig. 2)

NOTE: If installing on a fiberglass crossarm, the Fiberglass Crossarm Retrofit Kit (ITP10925) must be used to prevent damage to the crossarm.

3. To remove, reverse the installation procedure.

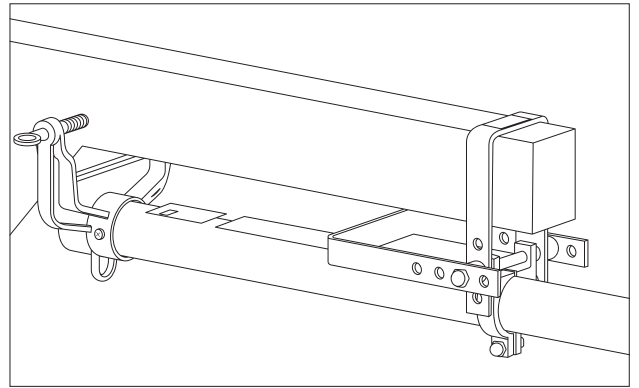

Fig. 1

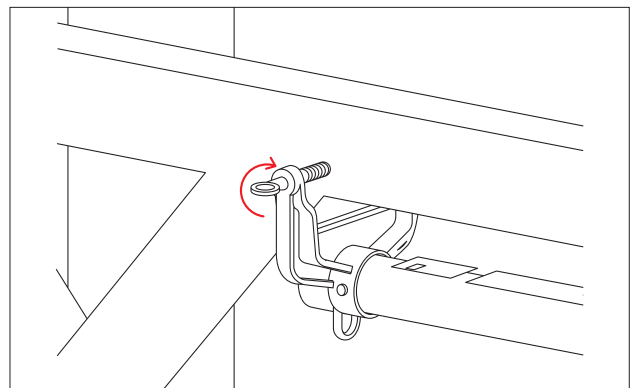
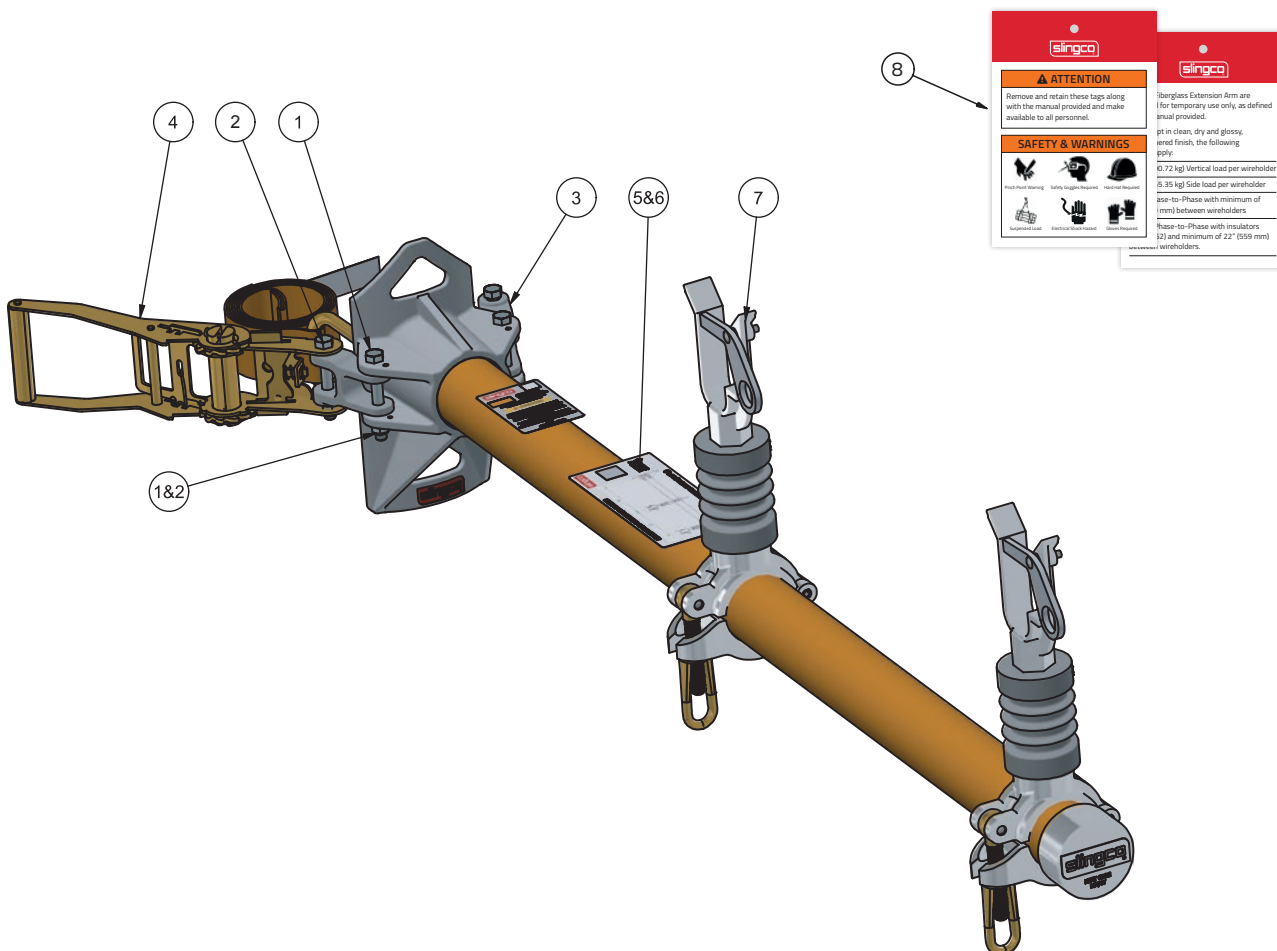

Fig. 2

REPLACEMENT PARTS FOR ITP14767 & ITP14771



| Item | Part Number | Description |
|------|-------------|---------------------------------------|
| 1 | ITP15388 | Hardware for Casting |
| 2 | ITP15389 | Hardware for Ratchet Strap Connection |
| 3 | ITP13342 | Ratchet Strap Connection Piece |
| 4 | ITP14765 | Ratchet Strap |
| 5 | LAB13713 | Wireholder Label for ITP14767 |
| 6 | LAB13711 | Wireholder Label for ITP14771 |
| 7 | ITP10466 | Wireholder with Insulator |
| 8 | LAB14264 | Weather Resistant Warning Tags |

REPLACEMENT PARTS FOR ITP14754 & ITP14726

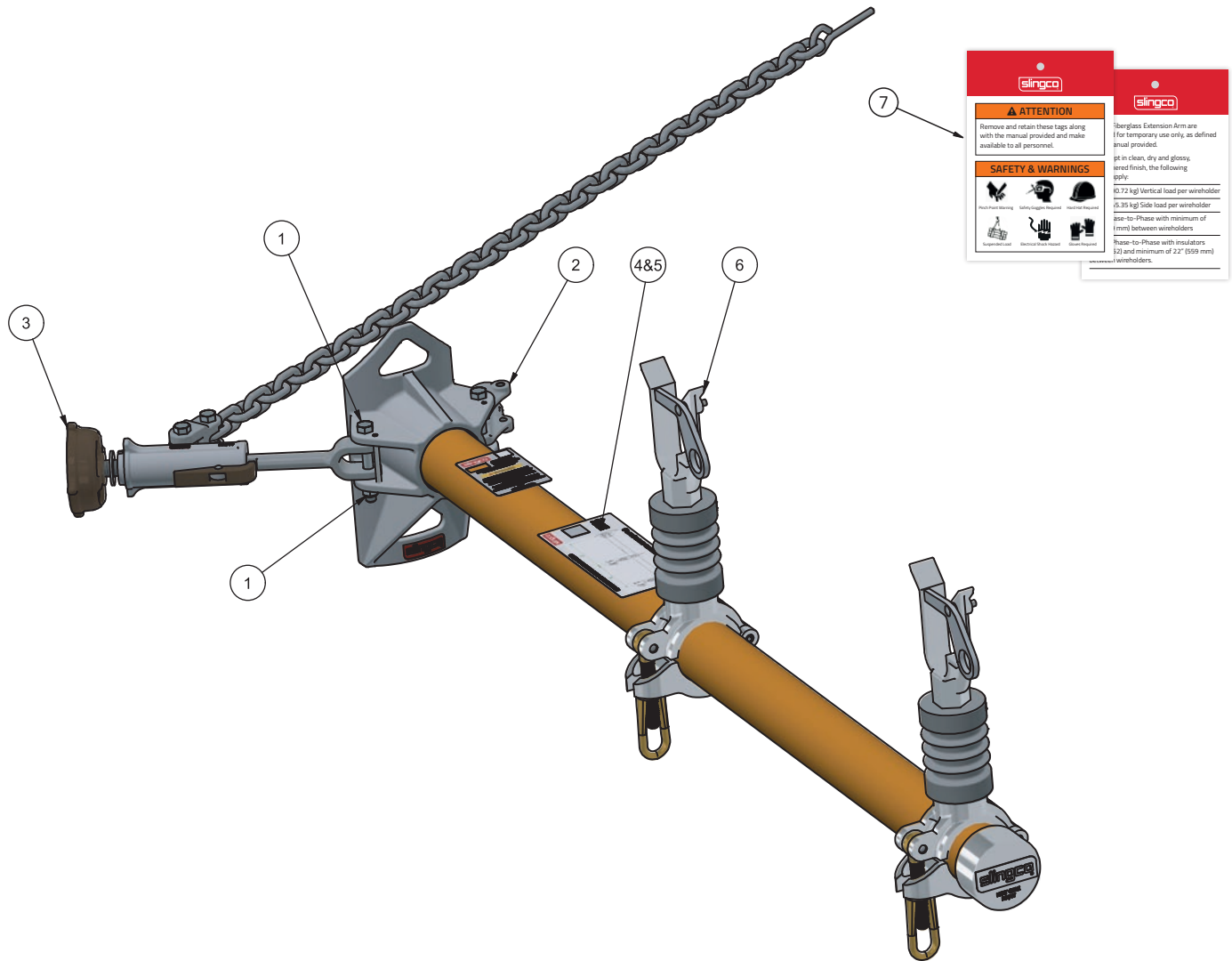

ATTENTION
Remove and retain these tags along with the manual provided and make available to all personnel.

SAFETY & WARNINGS

- Wear Safety Glasses
- Wear Safety Shoes
- Wear Safety Helmets
- Wear Safety Gloves
- Wear Safety Harness
- Wear Safety Belts
- Wear Safety Vests
- Wear Safety Helmets
- Wear Safety Helmets
- Wear Safety Helmets

fiberglass Extension Arm are for temporary use only, as defined in the manual provided.
 Clean, dry and glossy, steel finish, the following apply:
 10.72 kgj Vertical load per wireholder
 5.35 kgj Side load per wireholder
 Phase-to-Phase with minimum of 1mm between wireholders
 Phase-to-Phase with insulators (2' and minimum of 22" (559 mm) between wireholders.

| Item | Part Number | Description |
|------|-------------|--------------------------------|
| 1 | ITP15388 | Hardware for Casting |
| 2 | ITP13205 | Chain Holder Casting |
| 3 | ITP14727 | Chain Binder Assembly |
| 4 | LAB13328 | Wireholder Label for ITP14754 |
| 5 | LAB13327 | Wireholder Label for ITP14726 |
| 6 | ITP10466 | Wireholder with Insulator |
| 7 | LAB14264 | Weather Resistant Warning Tags |

WARNING LABELS

Slingco's Fiberglass Extension Arms are provided with the labels shown on these pages attached to them. They should be detached and kept along with this manual, and made available to all personnel.



⚠ ATTENTION

Remove and retain these tags along with the manual provided and make available to all personnel.

SAFETY & WARNINGS



Pinch Point Warning



Safety Goggles Required



Hard Hat Required



Suspended Load



Electrical Shock Hazard



Gloves Required



New and clean extension arms meet the requirements of ASTM F711, OSHA 1910.269 (j) (I), and OSHA 1926.957 (a) (i).

⚠ WARNING



Electrical Shock Hazard

Always maintain designated working clearances per OSHA or your company work methods, whichever distances are greater.

All fiberglass surfaces must be kept clean and dry at all times, adhering to OSHA requirements of inspection and wiping of high voltage rated fiberglass hotsticks.

WARNING LABELS



Slingco's Fiberglass Extension Arms are intended for temporary use only, as defined in the manual provided.

While kept in clean, dry and glossy, unweathered finish, the following ratings apply:

200 lb (90.72 kg) Vertical load per wireholder

100 lb (45.35 kg) Side load per wireholder

When two wireholders are present the below apply:

15kV Phase-to-Phase with minimum of 22" (559 mm) between wireholders

34.5kV Phase-to-Phase with insulators (ITP10352) and minimum of 22" (559 mm) between wireholders.



WARNING

All metal parts, including wireholders with or without insulators, must be considered energized whenever containing conductors.

ATTENTION

READ and **UNDERSTAND** all of the instructions and safety information in this manual before operating or servicing this tool.

Failure to read and understand these warnings and safe handling instructions could result in severe personal injury or death.

KEEP THIS MANUAL WITH TOOL.

WARNING

Cancer and Reproductive Harm www.P65Warnings.ca.gov



Slingco America, Inc.
3100 Jonquil Drive SE, Smyrna,
Georgia, 30080, USA
TOLL FREE: 888 685 9478
sales@slingcoamerica.com

888-685-9478

slingco.com

Slingco Limited
Gateway Business Park, New Hall Hey Road,
Rawtenstall, BB4 6JG, England
Tel: +44 [0]1706 855558
sales@slingco.com

+44 [0]1706 855558

Slingco Australia Pty. Ltd.
L9, 1 York Street, Sydney,
NSW 2000, Australia
Sales: +61 03 8840 6556
sales@slingcoaustralia.com.au

+61 03 8840 6556

Fiberglass Extension Arms Features And Safety Guide: LAB12545 – RevA Date July 2025

Slingco makes no warranty, express or implied, with respect to this product nor with respect to its specifications. In no event shall Slingco be liable for any direct, indirect, punitive, incidental, special consequential damages to property or life, whatsoever, arising out of or connected with the use or misuse of this product. This product is intended for use by qualified professionals having adequate knowledge of its proper use. July 2025 - v2.2