

The Slingco logo is a red rounded rectangle with the word "slingco" in white lowercase letters and a registered trademark symbol (®) to the right.

slingco®

A photograph of three marine workers in orange high-visibility gear and helmets working on a ship's deck. They are handling a large, dark, braided cable that is supported by a series of white cylindrical floats. The workers are positioned along the length of the cable, which is laid out on the deck. The background shows the complex metal structure of the ship's superstructure.

## SLINGCO MARINE PRODUCTS

CABLE INSTALLATION AND SUPPORT  
MADE A WHOLE LOT EASIER



## A GLOBAL BUSINESS BUILT ON QUALITY, INNOVATION, SERVICE ...AND REAL FAMILY TIES

**W**e've been living and breathing manufacturing for as long as we can remember. You can blame our Dad for that!

He founded Slingco more than 40 years ago. Since then, we've grown up and so has the company, evolving into an expert design and manufacturing operation, producing high quality tools for cable and conductor installation - products that are renowned for high performance in quality-critical applications.

Slingco America is based in Atlanta, Georgia, but you'll find our products around the world, making heavy-duty cable installation and support a whole lot easier for people working in industries as varied as public utilities, overhead line construction, oil and gas, marine and offshore, civil engineering, aerospace, transport, the military, performing arts, vehicle building, construction, and more.

You can't make mistakes when you're dealing with products like ours. Too much depends on them. That's why we're obsessive about quality and innovation in design and manufacturing, and why nothing leaves our hands that isn't 100% dependable.

Because we understand exactly what your operation needs, we also know cost is a factor. We keep our prices realistic and hold a vast range of stock for fast – even same day – delivery.

We're brothers, partners, and the driving force behind Slingco, but we're only a small part of the whole picture. We've got a fantastic team of skilled people who share our obsession with quality and great service. We're proud of every one of them.

Together, we're going to carry on developing outstanding products. We're going to carry on getting them out to you in record time. And we're going to carry on being the sort of company it's a pleasure to deal with.

MATT DYKINS  
PRESIDENT, SLINGCO AMERICA

NICK DYKINS  
CEO, SLINGCO LIMITED



# Cable installation, laying and support

## Products for offshore windfarms

We offer extensive ranges of marine cable grips and hose restraint cable grips for applications including onshore and offshore cable installation, support of cables inside wind turbines and general cable management. We have also developed a range of cable pulling grips for use in the installation of inter-array and export cables from offshore wind farm installations.

- Single Eye, Double Eye, Lace Up Cable Grips
- Max Break Load 10Te – 90Te+
- Galvanized, Stainless and Aramid Grips
- Complete range to suit Cable OD range  
0.39 in-11.6 in (10 mm-295 mm)
- Test reports & certification
- Large project delivery
- Quick availability
- 40+ years' experience
- Award winning company

### MARINE CABLE GRIPS FOR CLV

Our galvanized steel grips are heavy duty and suitable for array, export, fiber optic and umbilical cable installation. Available in single eye, double eye lace closed and double eye open lace up, sizes range from 3.5 in (90 mm) to over 11.8 in (300 mm). Break Load tested in-house on our 70Te Linear tensile tester. Also available in stainless steel.

Manufactured to order or from stock, subject to availability.

Now available without ferrules in a continuous weave to reduce clearance required through the CPS (Cable Protection System)

Also available in **Aramid (Non-Metallic)**. Lighter, stronger and suitable for subsea storage during prolonged cable laydown with great saltwater corrosion resistance. Reverse weaved (fewer ferrules) for improved clearance through the CPS.

### LACE-UP CABLE GRIPS

Our 'L-type' open grips are predominantly used for the temporary hang-off between the monopile and the nacelle turbine, where a 'typical' cable grip can't be fitted over a connector at the end of a cable. These grips are also used in pulling when the end of the cable is not accessible. The mesh is wrapped around the cable, then closed with the wire lace provided.

### WIND TURBINE CABLE SUPPORT GRIPS

These grips incorporate special features for wind turbines. Open ended double eye lace type offers reduced cable contact for high vibration environments while still allowing excellent working loads and cable support.



## CABLE GRIPS

### Marine Cable Grips for CLV

|                          |   |
|--------------------------|---|
| Aramid (Non-metallic)    | 4 |
| Galvanized (Low Load)    | 4 |
| Stainless (Low Load)     | 4 |
| Galvanized (Medium Load) | 5 |
| Galvanized (High Load)   | 5 |

### Wind Turbine Cable Grips

|   |   |
|---|---|
| LU Type Lace Up Open Cable Grip                           | 6 |
| Wind Turbine Support Grip - Heavy Duty Thimble Offset Eye | 6 |

### Fibre Optic Cable Grips

|                              |   |
|------------------------------|---|
| (FO) Fibre Optic Cable Grips | 7 |
|------------------------------|---|

## LINE PULLING SWIVELS

|                      |   |
|----------------------|---|
| Line Pulling Swivels | 8 |
|----------------------|---|

## CABLE PULLING HEADS & LAYING ROLLERS

|                                       |   |
|---------------------------------------|---|
| Cable Pulling Heads                   | 9 |
| 'V' Type Lead In Cable Laying Rollers | 9 |
| Quad Roller (Heavy Duty)              | 9 |

### WARNING

Cancer and Reproductive Harm [www.P65Warnings.ca.gov](http://www.P65Warnings.ca.gov)

Some of the products in this catalog are subject to Prop65 health warnings. For details, please contact us.

**PLEASE NOTE:** While every effort has been made to ensure accuracy of all content in this catalog, please confirm with your Slingco contact any critical information before purchase.

MARINE CABLE GRIPS FOR CLV



ARAMID (NON-METALLIC)

| Part Code   | Material | Range (in) | Range (mm) | Eye Type     | MBL (lb) | MBL (kg) | Lattice (in) | Lattice (mm) | Overall (in) | Overall (mm) | Thimble | Thimble Type | Ferrule | Ferrule Type |
|-------------|----------|------------|------------|--------------|----------|----------|--------------|--------------|--------------|--------------|---------|--------------|---------|--------------|
| ZCS10158    | Aramid   | 3 - 4      | 76 - 102   | Single       | 48,005   | 21,772   | 63.0         | 1,600        | 73.2         | 1,860        | No      | N/A          | No      | N/A          |
| ZCS14315    | Aramid   | 3.9 - 5.5  | 100 - 140  | Single       | 55,125   | 25,000   | 99.1         | 2,518        | 118.1        | 3,000        | Yes     | Nylon        | No      | N/A          |
| ZCS10159    | Aramid   | 4 - 5      | 102 - 127  | Single       | 45,505   | 20,638   | 63.0         | 1,600        | 73.2         | 1,860        | No      | N/A          | No      | N/A          |
| ZCS14221    | Aramid   | 5.7 - 7.5  | 145 - 190  | Single       | 66,150   | 30,000   | 94.5         | 2,400        | 112.2        | 2,850        | No      | N/A          | No      | N/A          |
| ZCS13459    | Aramid   | 5.9 - 7.1  | 150 - 180  | Single       | 66,150   | 30,000   | 78.7         | 2,000        | 110.2        | 2,800        | No      | N/A          | No      | N/A          |
| ZCS14221    | Aramid   | 5.7 - 7.5  | 145 - 190  | Single       | 66,150   | 30,000   | 94.5         | 2,400        | 112.2        | 2,850        | No      | N/A          | No      | N/A          |
| ZCS12482    | Aramid   | 9.1 - 11   | 230 - 280  | Single       | 66,150   | 30,000   | 104.3        | 2,650        | 104.3        | 2,650        | No      | N/A          | No      | N/A          |
| ZCS14301-3M | Aramid   | 9.8 - 11.8 | 250 - 300  | Double       | 156,555  | 71,000   | 119.1        | 3,026        | 149.6        | 3,800        | No      | N/A          | No      | N/A          |
| ZCS13464    | Aramid   | 5.9 - 7.9  | 150 - 200  | Double       | 88,200   | 40,000   | 78.7         | 2,000        | 106.3        | 2,700        | No      | N/A          | No      | N/A          |
| ZCS14314    | Aramid   | 3.9 - 5.5  | 100 - 140  | DE - Lace-up | 55,125   | 25,000   | 99.1         | 2,518        | 126.0        | 3,200        | Yes     | Nylon        | No      | N/A          |
| ZCS14477    | Aramid   | 7.7 - 8.7  | 195 - 220  | DE - Lace-up | 11,240   | 5,098    | 76.7         | 1,948        | 98.4         | 2,500        | Yes     | Nylon        | No      | N/A          |

GALVANIZED LOW LOAD

| Part Code | Material   | Range (in) | Range (mm) | Eye Type     | MBL (lb) | MBL (kg) | Lattice (in) | Lattice (mm) | Overall (in) | Overall (mm) | Thimble | Thimble Type | Ferrule | Ferrule Type |
|-----------|------------|------------|------------|--------------|----------|----------|--------------|--------------|--------------|--------------|---------|--------------|---------|--------------|
| ZCS14748  | Galvanized | 2.8 - 3.1  | 70 - 80    | Single       | 55,125   | 25,000   | 97.6         | 2,480        | 118.1        | 3,000        | Yes     | Steel        | Yes     | Steel        |
| ZCS12138  | Galvanized | 3.3 - 4.1  | 83 - 105   | Single       | 55,125   | 25,000   | 99.2         | 2,519        | 109.9        | 2,792        | Yes     | Steel        | Yes     | Steel        |
| ZCS12139  | Galvanized | 3.7 - 4.5  | 93 - 114   | Single       | 55,125   | 25,000   | 98.9         | 2,511        | 109.6        | 2,784        | Yes     | Steel        | Yes     | Steel        |
| ZCS3574   | Galvanized | 5.3 - 6.3  | 135 - 160  | Single       | 44,100   | 20,000   | 41.5         | 1,053        | 54.8         | 1,393        | No      | N/A          | Yes     | Alu          |
| ZCS10527  | Galvanized | 5.3 - 6.3  | 135 - 160  | Single       | 56,890   | 25,800   | 59.0         | 1,499        | 74.9         | 1,903        | Yes     | Steel        | Yes     | Alu          |
| ZCS12697  | Galvanized | 6.3 - 8.3  | 160 - 210  | Single       | 66,150   | 30,000   | 90.6         | 2,300        | 108.3        | 2,750        | Yes     | Steel        | Yes     | Alu          |
| ZCS3575   | Galvanized | 6.3 - 7.5  | 160 - 190  | Single       | 44,100   | 20,000   | 57.2         | 1,454        | 78.7         | 1,998        | No      | N/A          | Yes     | Alu          |
| ZCS3576   | Galvanized | 7.5 - 8.7  | 190 - 220  | Single       | 44,100   | 20,000   | 61.9         | 1,572        | 81.6         | 2,072        | No      | N/A          | Yes     | Alu          |
| ZCS3577   | Galvanized | 8.7 - 9.8  | 220 - 250  | Single       | 44,100   | 20,000   | 58.1         | 1,475        | 71.0         | 1,804        | No      | N/A          | Yes     | Alu          |
| ZCS12661  | Galvanized | 9.4 - 11   | 240 - 280  | Single       | 66,150   | 30,000   | 98.4         | 2,500        | 118.1        | 3,000        | Yes     | Steel        | Yes     | Alu          |
| ZCS3578   | Galvanized | 9.8 - 11.8 | 250 - 300  | Single       | 44,100   | 20,000   | 80.0         | 2,031        | 93.3         | 2,369        | No      | N/A          | Yes     | Alu          |
| ZCS13888  | Galvanized | 3.7 - 4.5  | 93 - 114   | Double       | 66,150   | 30,000   | 98.9         | 2,511        | 116.7        | 2,964        | No      | N/A          | Yes     | Steel        |
| ZCS3579   | Galvanized | 5.3 - 6.3  | 135 - 160  | Double       | 44,810   | 20,321   | 42.0         | 1,067        | 63.0         | 1,600        | No      | N/A          | Yes     | Alu          |
| ZCS3580   | Galvanized | 6.3 - 7.5  | 160 - 190  | Double       | 59,535   | 27,000   | 59.0         | 1,498        | 82.6         | 2,098        | No      | N/A          | Yes     | Alu          |
| ZCS3581   | Galvanized | 7.5 - 8.7  | 190 - 220  | Double       | 59,535   | 27,000   | 61.9         | 1,572        | 85.5         | 2,172        | No      | N/A          | Yes     | Alu          |
| ZCS3582   | Galvanized | 8.7 - 9.8  | 220 - 250  | Double       | 59,535   | 27,000   | 52.2         | 1,327        | 75.9         | 1,927        | No      | N/A          | Yes     | Alu          |
| ZCS3583   | Galvanized | 9.8 - 11.8 | 250 - 300  | Double       | 47,410   | 21,500   | 80.0         | 2,031        | 107.5        | 2,731        | No      | N/A          | Yes     | Alu          |
| ZCS14749  | Galvanized | 2.8 - 3.1  | 70 - 80    | DE - Lace Up | 55,125   | 25,000   | 97.6         | 2,480        | 126.0        | 3,200        | Yes     | Steel        | Yes     | Steel        |
| ZCS12140  | Galvanized | 3.7 - 4.5  | 93 - 114   | DE - Lace Up | 55,125   | 25,000   | 98.9         | 2,511        | 116.7        | 2,964        | Yes     | Steel        | Yes     | Steel        |
| ZCS12141  | Galvanized | 3.3 - 4.1  | 83 - 105   | DE - Lace Up | 66,150   | 30,000   | 98.2         | 2,494        | 117.0        | 2,972        | Yes     | Steel        | Yes     | Steel        |
| ZCS7496   | Galvanized | 3.9 - 4.9  | 100 - 125  | DE - Lace Up | 57,595   | 26,120   | 78.9         | 2,005        | 100.6        | 2,555        | Yes     | Steel        | Yes     | Steel        |
| ZCS3584   | Galvanized | 5.3 - 6.3  | 135 - 160  | DE - Lace Up | 38,085   | 17,273   | 47.6         | 1,208        | 71.2         | 1,808        | No      | N/A          | Yes     | Alu          |
| ZCS3585   | Galvanized | 6.3 - 7.5  | 160 - 190  | DE - Lace Up | 38,085   | 17,273   | 59.0         | 1,498        | 82.6         | 2,098        | No      | N/A          | Yes     | Alu          |
| ZCS3586   | Galvanized | 7.5 - 8.7  | 190 - 220  | DE - Lace Up | 38,085   | 17,272   | 61.9         | 1,572        | 85.5         | 2,172        | No      | N/A          | Yes     | Alu          |
| ZCS3587   | Galvanized | 8.7 - 9.8  | 220 - 250  | DE - Lace Up | 38,085   | 17,272   | 59.7         | 1,517        | 83.3         | 2,117        | No      | N/A          | Yes     | Alu          |
| ZCS12979  | Galvanized | 8.7 - 9.8  | 220 - 250  | DE - Lace Up | 50,715   | 23,000   | 52.2         | 1,327        | 75.9         | 1,927        | No      | N/A          | Yes     | Alu          |
| ZCS12725  | Galvanized | 9.4 - 11   | 240 - 280  | DE - Lace Up | 66,150   | 30,000   | 98.4         | 2,500        | 122.0        | 3,100        | Yes     | Steel        | Yes     | Alu          |

STAINLESS LOW LOAD

| Part Code | Material        | Range (in) | Range (mm) | Eye Type | MBL (lb) | MBL (kg) | Lattice (in) | Lattice (mm) | Overall (in) | Overall (mm) | Thimble | Thimble Type | Ferrule | Ferrule Type |
|-----------|-----------------|------------|------------|----------|----------|----------|--------------|--------------|--------------|--------------|---------|--------------|---------|--------------|
| ZCS3254   | Stainless Steel | 3 - 3.5    | 76 - 89    | Double   | 39,205   | 17,781   | 54.7         | 1,390        | 79.5         | 2,020        | No      | N/A          | Yes     | Copper       |
| ZCS11397  | Stainless Steel | 3.4 - 4.2  | 87 - 107   | Single   | 33,075   | 15,000   | 87.0         | 2,210        | 96.5         | 2,450        | Yes     | Steel        | Yes     | Steel        |
| ZCS11395  | Stainless Steel | 4.3 - 5.2  | 109 - 133  | Single   | 33,075   | 15,000   | 77.6         | 1,971        | 84.6         | 2,148        | Yes     | Steel        | Yes     | Steel        |
| ZCS09391  | Stainless Steel | 4.9 - 5.9  | 125 - 150  | Single   | 55,300   | 25,080   | 98.4         | 2,500        | 111.0        | 2,820        | Yes     | Steel        | Yes     | Steel        |
| ZCS14792  | Stainless Steel | 5.3 - 6.3  | 135 - 160  | Double   | 40,795   | 18,500   | 59.8         | 1,519        | 84.6         | 2,150        | No      | n/a          | Yes     | Steel        |
| ZCS14793  | Stainless Steel | 6.3 - 7.5  | 160 - 190  | Double   | 48,510   | 22,000   | 59.0         | 1,498        | 82.6         | 2,098        | No      | n/a          | Yes     | Steel        |

## MARINE CABLE GRIPS FOR CLV (continued)

### GALVANIZED MEDIUM LOAD

| Part Code          | Material   | Range (in) | Range (mm) | Eye Type     | MBL (lb) | MBL (kg) | Lattice (in) | Lattice (mm) | Overall (in) | Overall (mm) | Thimble | Thimble Type | Ferrule | Ferrule Type |
|--------------------|------------|------------|------------|--------------|----------|----------|--------------|--------------|--------------|--------------|---------|--------------|---------|--------------|
| ZCS3525            | Galvanized | 3.9 - 4.9  | 100 - 125  | Single       | 100,040  | 45,370   | 78.9         | 2,005        | 98.4         | 2,500        | No      | N/A          | Yes     | Alu          |
| ZCS3525-THI        | Galvanized | 3.9 - 4.9  | 100 - 125  | Single       | 100,330  | 45,500   | 98.4         | 2,500        | 114.4        | 2,905        | Yes     | Steel        | Yes     | Alu          |
| ZCS3525-2.5M       | Galvanized | 3.9 - 4.9  | 100 - 125  | Single       | 100,330  | 45,500   | 98.4         | 2,500        | 114.4        | 2,905        | No      | N/A          | Yes     | Alu          |
| ZCS3525-3M         | Galvanized | 3.9 - 4.9  | 100 - 125  | Single       | 100,330  | 45,500   | 118.1        | 3,000        | 134.1        | 3,405        | No      | N/A          | Yes     | Alu          |
| ZCS3526            | Galvanized | 4.9 - 5.9  | 125 - 150  | Single       | 105,050  | 47,640   | 71.7         | 1,821        | 89.7         | 2,279        | No      | N/A          | Yes     | Alu          |
| ZCS3526THI         | Galvanized | 4.9 - 5.9  | 125 - 150  | Single       | 105,050  | 47,640   | 71.7         | 1,821        | 89.7         | 2,279        | Yes     | Steel        | Yes     | Alu          |
| ZCS3526-3M         | Galvanized | 4.9 - 5.9  | 125 - 150  | Single       | 105,050  | 47,640   | 118.1        | 3,000        | 137.8        | 3,500        | No      | N/A          | Yes     | Alu          |
| ZCS11934           | Galvanized | 5.1 - 6.9  | 130 - 176  | Single       | 110,250  | 50,000   | 102.5        | 2,604        | 81.9         | 2,080        | No      | N/A          | Yes     | Alu          |
| ZCS11934-4M        | Galvanized | 5.1 - 6.9  | 130 - 176  | Single       | 110,250  | 50,000   | 157.1        | 3,990        | 175.8        | 4,466        | No      | N/A          | Yes     | Alu          |
| ZCS11776           | Galvanized | 5.5 - 6.9  | 140 - 176  | Single       | 112,455  | 51,000   | 78.7         | 2,000        | 91.5         | 2,325        | No      | N/A          | Yes     | Alu          |
| ZCS3527            | Galvanized | 5.9 - 7.9  | 150 - 200  | Single       | 112,045  | 50,815   | 70.9         | 1,800        | 91.1         | 2,315        | No      | N/A          | Yes     | Alu          |
| ZCS3215            | Galvanized | 7.9 - 8.7  | 200 - 220  | Single       | 88,200   | 40,000   | 78.7         | 2,000        | 103.5        | 2,630        | No      | N/A          | Yes     | Alu          |
| ZCS12740-THI-2M    | Galvanized | 3.5 - 4.9  | 90 - 125   | Single       | 110,250  | 50,000   | 78.7         | 1,998        | 98.4         | 2,500        | Yes     | Steel        | Yes     | Alu          |
| ZCS12740-THI-ST-2M | Galvanized | 3.5 - 4.9  | 90 - 125   | Single       | 110,250  | 50,000   | 78.7         | 1,998        | 98.4         | 2,500        | Yes     | Steel        | Yes     | Steel        |
| ZCS13507-THI-3M    | Galvanized | 5.5 - 7.1  | 140 - 180  | Double       | 88,200   | 40,000   | 118.1        | 3,000        | 145.7        | 3,700        | Yes     | Steel        | Yes     | Alu          |
| ZCS3545            | Galvanized | 3.9 - 4.9  | 100 - 125  | DE - Lace Up | 105,840  | 48,000   | 78.9         | 2,005        | 100.6        | 2,555        | No      | N/A          | Yes     | Alu          |
| ZCS3545-THI        | Galvanized | 3.9 - 4.9  | 100 - 125  | DE - Lace Up | 105,840  | 48,000   | 78.9         | 2,005        | 99.3         | 2,522        | Yes     | Steel        | Yes     | Alu          |
| ZCS14953           | Galvanized | 3.9 - 5.5  | 100 - 140  | DE - Lace Up | 99,230   | 45,000   | 98.4         | 2,500        | 126.0        | 3,200        | No      | N/A          | No      | N/A          |
| ZCS3546            | Galvanized | 4.9 - 5.9  | 125 - 150  | DE - Lace Up | 105,840  | 48,000   | 71.7         | 1,821        | 93.3         | 2,371        | No      | N/A          | Yes     | Alu          |
| ZCS3546THI         | Galvanized | 4.9 - 5.9  | 125 - 150  | DE - Lace Up | 105,840  | 48,000   | 71.7         | 1,821        | 93.3         | 2,371        | Yes     | Steel        | Yes     | Alu          |
| ZCS12691-THI       | Galvanized | 5.9 - 7.5  | 150 - 190  | DE - Lace Up | 99,230   | 45,000   | 78.7         | 2,000        | 118.1        | 3,000        | Yes     | Steel        | Yes     | Alu          |
| ZCS12689           | Galvanized | 5.9 - 7.5  | 150 - 190  | DE - Lace Up | 99,230   | 45,000   | 98.4         | 2,500        | 126.0        | 3,200        | No      | N/A          | Yes     | Alu          |
| ZCS3547            | Galvanized | 5.9 - 7.9  | 150 - 200  | DE - Lace Up | 105,840  | 48,000   | 66.1         | 1,678        | 87.7         | 2,228        | No      | N/A          | Yes     | Alu          |
| ZCS3547-THI        | Galvanized | 5.9 - 7.9  | 150 - 200  | DE - Lace Up | 66,150   | 30,000   | 66.1         | 1,678        | 87.7         | 2,228        | Yes     | Steel        | Yes     | Alu          |
| ZCS11948-THI       | Galvanized | 8.7 - 10.2 | 220 - 260  | DE - Lace Up | 99,230   | 45,000   | 79.4         | 2,018        | 101.1        | 2,568        | Yes     | Steel        | Yes     | Steel        |

### GALVANIZED HIGH LOAD

| Part Code          | Material   | Range (in)  | Range (mm) | Eye Type     | MBL (lb) | MBL (kg) | Lattice (in) | Lattice (mm) | Overall (in) | Overall (mm) | Thimble | Thimble Type | Ferrule | Ferrule Type |
|--------------------|------------|-------------|------------|--------------|----------|----------|--------------|--------------|--------------|--------------|---------|--------------|---------|--------------|
| ZCS12741-THI-2.5M  | Galvanized | 4.3-6.5     | 110-165    | Single       | 121275   | 55000    | 93.2         | 2367         | 113.3        | 2879         | Yes     | Steel        | Yes     | Alu          |
| ZCS12742-THI-3M    | Galvanized | 5.1-7       | 130-178    | Single       | 143330   | 65000    | 116.9        | 2969         | 137.8        | 3500         | Yes     | Steel        | Yes     | Alu          |
| ZCS12742-THI-ST-3M | Galvanized | 5.1-7       | 130-178    | Single       | 143330   | 65000    | 116.9        | 2969         | 137.8        | 3500         | Yes     | Steel        | Yes     | Steel        |
| ZCS12743-THI-3M    | Galvanized | 6.1-8.3     | 155-210    | Single       | 154350   | 70000    | 118.9        | 3021         | 137.8        | 3500         | Yes     | Steel        | Yes     | Alu          |
| ZCS12743-THI-3M    | Galvanized | 6.1-8.3     | 155-210    | Single       | 154350   | 70000    | 118.9        | 3021         | 137.8        | 3500         | Yes     | Steel        | Yes     | Alu          |
| ZCS12744-THI-3M    | Galvanized | 7.7-9.8     | 195-250    | Single       | 187425   | 85000    | 119.4        | 3032         | 137.8        | 3500         | Yes     | Steel        | Yes     | Alu          |
| ZCS12744-THI-3M    | Galvanized | 7.7-9.8     | 195-250    | Single       | 187430   | 85000    | 119.4        | 3032         | 137.8        | 3500         | Yes     | Steel        | Yes     | Alu          |
| ZCS3528            | Galvanized | 7.9-10.0    | 200-255    | Single       | 138035   | 62600    | 80.6         | 2047         | 99.3         | 2523         | No      | N/A          | Yes     | Alu          |
| ZCS09216           | Galvanized | 7.9-10.0    | 200-255    | Single       | 138035   | 62600    | 118.1        | 3000         | 137.8        | 3500         | No      | N/A          | Yes     | N/A          |
| ZCS3528THI         | Galvanized | 7.9-10      | 200-255    | Single       | 138030   | 62600    | 78.7         | 2000         | 102.4        | 2600         | Yes     | Alu          | Yes     | Alu          |
| ZCS12745-THI-3M    | Galvanized | 9.3-11.8    | 235-300    | Single       | 198450   | 90000    | 114.2        | 2900         | 137.8        | 3500         | Yes     | Steel        | Yes     | Alu          |
| ZCS3529            | Galvanized | 10.0 - 12.0 | 255-305    | Single       | 138035   | 62,600   | 76.6         | 1945         | 95.3         | 2421         | No      | N/A          | Yes     | Alu          |
| ZCS3530            | Galvanized | 12.0 - 14.0 | 305-355    | Single       | 138035   | 62600    | 96.9         | 2460         | 115.6        | 2936         | No      | N/A          | Yes     | Alu          |
| ZCS3535            | Galvanized | 3.9-4.9     | 100 - 125  | Double       | 114660   | 52000    | 78.9         | 2005         | 100.6        | 2555         | No      | N/A          | Yes     | Alu          |
| ZCS15494           | Galvanized | 3.9-5.5     | 100-140    | Double       | 99230    | 45000    | 78.7         | 2000         | 106.3        | 2700         | No      | N/A          | No      | N/A          |
| ZCS12755-THI-2.5M  | Galvanized | 4.3 - 6.5   | 110-165    | Double       | 132300   | 60000    | 98.0         | 2488         | 126.0        | 3200         | Yes     | Steel        | Yes     | Alu          |
| ZCS3536            | Galvanized | 4.9-5.9     | 125 - 150  | Double       | 123040   | 55,800   | 71.7         | 1821         | 93.3         | 2371         | No      | N/A          | Yes     | Alu          |
| ZCS12756-THI-3M    | Galvanized | 5.1-7       | 130-178    | Double       | 165380   | 75000    | 116.9        | 2969         | 149.6        | 3800         | Yes     | Steel        | Yes     | Alu          |
| ZCS3537            | Galvanized | 5.9-7.9     | 150-200    | Double       | 127560   | 57850    | 70.9         | 1800         | 103.0        | 2615         | No      | N/A          | Yes     | Alu          |
| ZCS12757-THI-3M    | Galvanized | 6.1-9.1     | 155-230    | Double       | 176400   | 80000    | 113.3        | 2877         | 143.9        | 3656         | Yes     | Steel        | Yes     | Alu          |
| ZCS12758-THI-3M    | Galvanized | 7.7-9.8     | 195-250    | Double       | 198450   | 90000    | 119.4        | 3032         | 153.5        | 3900         | Yes     | Steel        | Yes     | Alu          |
| ZCS3538            | Galvanized | 7.9-10      | 200-255    | Double       | 156555   | 71000    | 80.6         | 2047         | 102.2        | 2597         | No      | N/A          | Yes     | Alu          |
| ZCS3538THI         | Galvanized | 7.9-10      | 200-255    | Double       | 156560   | 71000    | 78.7         | 2000         | 102.4        | 2600         | Yes     | Steel        | Yes     | Alu          |
| ZCS09330           | Galvanized | 7.9-10.2    | 200-260    | Double       | 156560   | 71000    | 118.1        | 3000         | 139.8        | 3550         | Yes     | Steel        | Yes     | Steel        |
| ZCS12759-THI-3M    | Galvanized | 9.3-11.8    | 235-300    | Double       | 209480   | 95000    | 118.1        | 3000         | 153.5        | 3900         | Yes     | Steel        | Yes     | Alu          |
| ZCS09331           | Galvanized | 10-12       | 254-305    | Double       | 156560   | 71000    | 118.1        | 3000         | 139.8        | 3550         | Yes     | Steel        | Yes     | Alu          |
| ZCS3539            | Galvanized | 10.0 - 12.0 | 255-305    | Double       | 156555   | 71000    | 76.6         | 1945         | 98.2         | 2495         | No      | N/A          | Yes     | Alu          |
| ZCS3540            | Galvanized | 12.0-14.0   | 305-355    | Double       | 156555   | 71000    | 96.9         | 2460         | 124.4        | 3159         | No      | N/A          | Yes     | Alu          |
| ZCS12754-THI-2M    | Galvanized | 3.5-4.9     | 90-125     | Double       | 121275   | 55000    | 78.7         | 2000         | 106.3        | 2700         | Yes     | Steel        | Yes     | Alu          |
| ZCS14953           | Galvanized | 3.9-5.5     | 100-140    | DE - Lace Up | 99230    | 45000    | 98.4         | 2500         | 126.0        | 3200         | No      | N/A          | No      | N/A          |
| ZCS12761-THI-2.5M  | Galvanized | 4.3-6.5     | 110-165    | DE - Lace Up | 110250   | 50000    | 98.4         | 2500         | 126.0        | 3200         | Yes     | Steel        | Yes     | Alu          |
| ZCS12762-THI-3M    | Galvanized | 5.1-7       | 130-178    | DE - Lace Up | 132300   | 60000    | 118.1        | 3000         | 145.7        | 3700         | Yes     | Steel        | Yes     | Alu          |
| ZCS16101-2M        | Galvanized | 5.9-7.5     | 150-190    | DE - Lace Up | 77180    | 35000    | 78.7         | 2000         | 102.4        | 2600         | No      | N/A          | No      | N/A          |
| ZCS16101-3M        | Galvanized | 5.9-7.5     | 150-190    | DE - Lace Up | 88200    | 40000    | 118.1        | 3000         | 141.7        | 3600         | No      | N/A          | No      | N/A          |
| ZCS3548            | Galvanized | 7.9-10.0    | 200 - 255  | DE - Lace Up | 132300   | 60000    | 80.6         | 2047         | 102.2        | 2597         | No      | N/A          | Yes     | Alu          |
| ZCS3548-THI-2M     | Galvanized | 8.7-10      | 220-255    | DE - Lace Up | 132300   | 60000    | 80.6         | 2047         | 102.2        | 2597         | Yes     | Steel        | Yes     | Alu          |
| ZCS16103           | Galvanized | 9.6-11.8    | 245-300    | DE - Lace Up | 132300   | 60000    | 114.2        | 2900         | 141.7        | 3600         | No      | N/A          | No      | N/A          |

WIND TURBINE CABLE GRIPS

LU TYPE LACE UP OPEN CABLE GRIP

Ideal for light to medium loads; the LU Type is fitted to the cable being pulled by stitching it together, like a football. Mainly used where a 'typical' cable grip can't be fitted over a connector at the end of a cable and can be used to temporarily hang off the cables. For use in pulling when the end is not accessible. The LU Type is wrapped around the cable, then closed with the wire lace provided.



| Slingco Part No                                    | Range        |           | Lattice Weave | Lattice Length |      | Overall Length |       | Approx. Break Load |        |
|--|--------------|-----------|---------------|----------------|------|----------------|-------|--------------------|--------|
|  | in           | mm        |               | in             | mm   | in             | mm    | lb                 | kg     |
| <b>LACE UP STANDARD GRIP - GALVANIZED</b>          |              |           |               |                |      |                |       |                    |        |
| ZCS1157  | 0.25 - 0.50  | 6 - 13    | Single        | 8              | 210  | 15             | 380   | 1,680              | 760    |
| ZCS0872  | 0.50 - 0.75  | 13 - 19   | Single        | 17             | 429  | 22             | 552   | 2,240              | 1,015  |
| ZCS0871  | 0.75 - 1.00  | 19 - 25   | Double        | 15             | 369  | 23             | 590   | 5,600              | 2,540  |
| ZCS0328  | 1.00 - 1.50  | 25 - 38   | Single        | 15             | 375  | 21             | 545   | 7,849              | 3,555  |
| ZCS0329  | 1.50 - 2.00  | 38 - 50   | Double        | 27             | 679  | 36             | 909   | 11,200             | 5,080  |
| ZCS0330  | 2.00 - 2.50  | 50 - 63   | Double        | 24             | 610  | 34             | 865   | 11,200             | 5,080  |
| ZCS0331  | 2.50 - 3.50  | 63 - 89   | Double        | 22             | 685  | 31             | 793   | 13,440             | 6,095  |
| ZCS0853  | 3.50 - 4.50  | 89 - 115  | Double        | 28             | 708  | 40             | 1,006 | 15,680             | 7,110  |
| ZCS1109  | 4.50 - 5.50  | 115 - 140 | Double        | 28             | 700  | 39             | 990   | 15,680             | 7,110  |
| ZCS4463  | 4.72 - 5.90  | 120 - 150 | Triple        | 62             | 1582 | 86             | 2,182 | 32,400             | 14,700 |
| ZCS3584  | 5.31 - 6.30  | 135 - 160 | Double        | 48             | 1208 | 71             | 1,808 | 38,080             | 17,000 |
| ZCS3585  | 6.33 - 7.48  | 161 - 190 | Double        | 59             | 1500 | 83             | 2,100 | 38,080             | 17,000 |
| ZCS3586  | 7.51 - 8.66  | 191 - 220 | Double        | 62             | 1572 | 86             | 2,172 | 38,080             | 17,000 |
| ZCS3587  | 8.70 - 9.84  | 221 - 250 | Double        | 59             | 1500 | 83             | 2,100 | 38,080             | 17,000 |
| ZCS3588  | 9.88 - 11.81 | 251 - 300 | Double        | 80             | 2031 | 108            | 2,731 | 38,080             | 17,000 |
| <b>LACE UP STANDARD GRIP - 316 STAINLESS STEEL</b> |              |           |               |                |      |                |       |                    |        |
| ZCS1983  | 0.25 - 0.50  | 6 - 13    | Single        | 9              | 230  | 12             | 305   | 1,344              | 610    |
| ZCS1796  | 0.50 - 0.75  | 13 - 19   | Single        | 17             | 429  | 24             | 605   | 1,792              | 810    |
| ZCS1789  | 0.75 - 1.00  | 19 - 25   | Single        | 14             | 359  | 21             | 539   | 4,480              | 2,030  |
| ZCS1797  | 1.00 - 1.50  | 25 - 38   | Single        | 15             | 375  | 22             | 552   | 6,272              | 2,845  |
| ZCS1984  | 1.50 - 2.00  | 38 - 50   | Double        | 27             | 679  | 35             | 882   | 8,960              | 4,065  |
| ZCS2466  | 2.00 - 2.50  | 50 - 63   | Double        | 24             | 610  | 34             | 865   | 8,960              | 4,065  |
| ZCS0816  | 2.50 - 3.50  | 63 - 89   | Double        | 22             | 548  | 31             | 788   | 10,752             | 4,875  |
| ZCS5094  | 2.75 - 3.44  | 69 - 87   | Multiple      | 54             | 1362 | 80             | 2041  | 40,000             | 18,140 |
| ZCS1356  | 3.50 - 4.50  | 89 - 115  | Double        | 21             | 540  | 33             | 845   | 12,544             | 5,690  |
| ZCS2832  | 3.50 - 4.50  | 89 - 115  | Triple        | 23             | 574  | 35             | 879   | 14,012             | 6,300  |
| ZCS1355  | 4.50 - 5.50  | 115 - 140 | Double        | 27             | 685  | 39             | 990   | 12,544             | 5,690  |
| ZCS2833  | 4.50 - 5.50  | 115 - 140 | Triple        | 29             | 730  | 41             | 1,035 | 16,128             | 7,315  |

WIND TURBINE SUPPORT GRIP - HEAVY DUTY THIMBLE OFFSET EYE

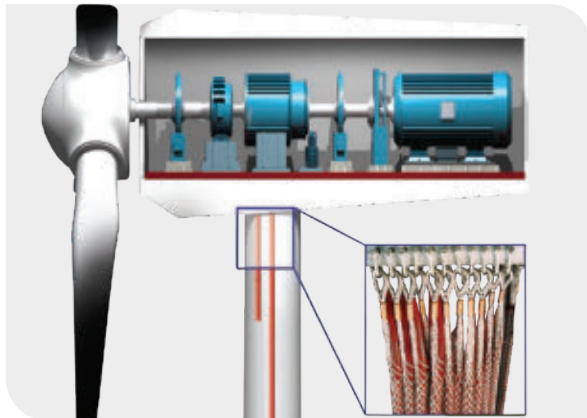

Slingco has developed a range of cable grips tailored for the renewable energy sector for use in:

- Cable installation – onshore and offshore
- Cable support inside wind turbines
- Cable management

For wind turbines, special features have been adapted to allow for minimal contact with the actual cable while still allowing excellent working loads and cable support.

The Slingco Wind Turbine Support Grip is manufactured from 316 Stainless Steel and provides cable support and control inside the wind turbine. It features rounded copper ferrules and offers reduced cable contact for high vibration environments. Custom grips can be adapted to meet any requirement.



| Slingco Part No | Range       |          | Lattice Length |       | Approx. Break Load |       |
|-----------------|-------------|----------|----------------|-------|--------------------|-------|
|                 | in          | mm       | in             | mm    | lb                 | kg    |
| ZCS2844         | 0.31 - 0.40 | 8 - 10   | 19             | 480   | 1,455              | 660   |
| ZCS2845         | 0.40 - 0.60 | 10 - 15  | 17             | 432   | 2,284              | 1,036 |
| ZCS2846         | 0.60 - 0.80 | 15 - 20  | 17             | 432   | 2,901              | 1,316 |
| ZCS2847         | 0.80 - 0.99 | 20 - 25  | 18             | 461   | 4,586              | 2,080 |
| ZCS2848         | 1.0 - 1.19  | 25 - 30  | 16             | 413   | 5,467              | 2,480 |
| ZCS2849         | 1.20 - 1.58 | 30 - 40  | 19             | 470   | 7,716              | 3,500 |
| ZCS2850         | 1.58 - 1.98 | 40 - 50  | 32             | 825   | 10,781             | 4,890 |
| ZCS2851         | 1.98 - 2.37 | 50 - 60  | 30             | 751   | 10,791             | 4,895 |
| ZCS2852         | 2.38 - 2.77 | 60 - 70  | 31             | 788   | 14,163             | 6,424 |
| ZCS2853         | 2.77 - 3.55 | 70 - 90  | 45             | 1,135 | 14,163             | 6,424 |
| ZCS2854         | 3.55 - 4.33 | 90 - 110 | 31             | 799   | 18,367             | 8,331 |

## FIBER OPTIC CABLE GRIPS

This grip's triple weave construction is ideal for heavy loads. FO (Fiber Optic) cable grips are color coded for ease of identification. Used for the installation of fibre optic cables in a subsea environment for temporary pull-in. Use with bare or insulated cable, conductor or wire. Made of Galvanized Steel.

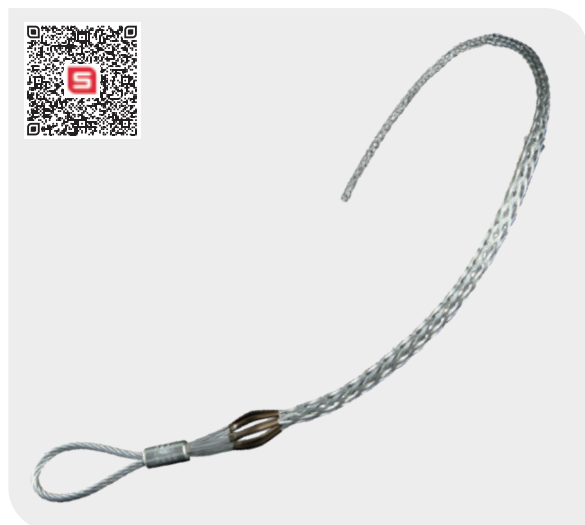

| Slingco Part No | Color Code  | Range       |          | Lattice Length |       | Approx. Break Load |        |
|-----------------|-------------|-------------|----------|----------------|-------|--------------------|--------|
|                 |             | in          | mm       | in             | mm    | lb                 | kg     |
| ZCS1710         | Dark Green  | 0.25 - 0.50 | 6 - 13   | 28             | 720   | 7,000              | 3,170  |
| ZCS1711         | Brown       | 0.50 - 0.75 | 13 - 19  | 39             | 978   | 10,500             | 4,760  |
| ZCS1712         | Light Blue  | 0.75 - 1.00 | 19 - 25  | 43             | 1,092 | 14,100             | 6,395  |
| ZCS1713         | Gold        | 1.00 - 1.25 | 25 - 32  | 58             | 1,470 | 25,000             | 11,340 |
| ZCS1714         | Black       | 1.25 - 1.50 | 32 - 38  | 51             | 1,291 | 31,000             | 14,065 |
| ZCS1715         | Red         | 1.50 - 1.75 | 38 - 44  | 68             | 1,739 | 31,000             | 14,065 |
| ZCS1716         | Dark Blue   | 1.75 - 2.25 | 44 - 57  | 69             | 1,747 | 49,000             | 22,230 |
| ZCS1750         | Yellow      | 2.00 - 2.50 | 51 - 63  | 54             | 1,370 | 49,000             | 22,230 |
| ZCS1751         | Orange      | 2.50 - 3.00 | 63 - 76  | 52             | 1,311 | 49,000             | 22,230 |
| ZCS1752         | Aluminum    | 3.00 - 3.50 | 76 - 89  | 53             | 1,342 | 49,000             | 22,230 |
| ZCS1753         | Light Green | 3.50 - 4.00 | 89 - 102 | 53             | 1,351 | 49,000             | 22,230 |

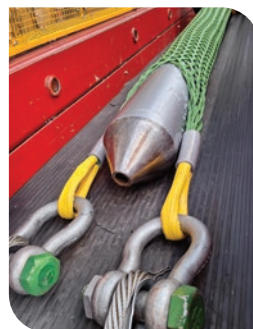
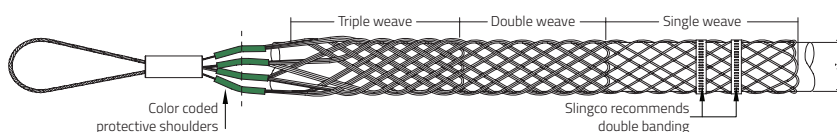

**NON-METALLIC**  
Corrosion resistant.

**LIGHTER**  
Easy to install, save time.

**NO FERRULES**  
Better clearance through the CPS (Cable Protection System).

■ Break loads and lengths shown in this brochure are as a guide only – for exact calculations please refer to data sheets which can be obtained from [sales@slingcoamerica.com](mailto:sales@slingcoamerica.com)  
 ■ For socks/stockings above 5.5 in (140 mm) diameter please contact [sales@slingcoamerica.com](mailto:sales@slingcoamerica.com)

LINE PULLING SWIVELS



Swivels are important in pulling when lines develop torsion during installation. They help release torque and prevent it from reaching dangerous levels, which can cause damage to the cable.

All Slingco Swivels are designed to the highest specifications and are stringently quality tested and inspected to ensure optimum performance and reliability.

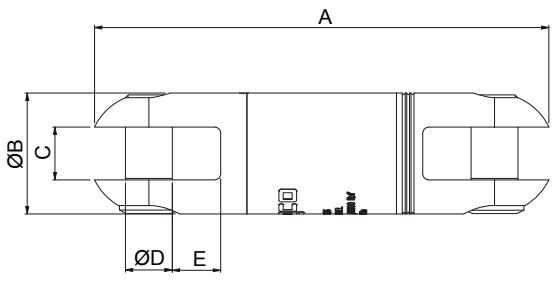

| Slingco part no. | Material with zinc plating | Safe working load |       | A length |       | Ø B  |      | C    |      | Ø D Pin |      | E Recess |      | Weight |      |
|------------------|----------------------------|-------------------|-------|----------|-------|------|------|------|------|---------|------|----------|------|--------|------|
|                  |                            | (lb)              | (kN)  | (in)     | (mm)  | (in) | (mm) | (in) | (mm) | (in)    | (mm) | (in)     | (mm) | (lb)   | (kg) |
| ZSW2097          | EN8                        | 15,000            | 66.7  | 7.34     | 186.4 | 2.09 | 53   | 0.79 | 20   | 0.71    | 18   | 0.83     | 21   | 4.59   | 2.1  |
| ZSW2857          | EN24                       | 30,000            | 133.4 | 11.13    | 282.6 | 2.50 | 63.5 | 1.00 | 25.4 | 0.875   | 22.2 | 1.13     | 28.6 | 10.44  | 4.7  |

**SAFETY NOTE:** All Slingco Line Pulling Swivels are designed for straight line pulling and will not support side loads as would be encountered traveling over a bull wheel. Swivel selection should be based on pulling line diameter, grip size, opening dimensions, pin sizes, working load, and sheave groove diameter. Swivels are not designed for general lifting.



Performance.  
Under the toughest conditions.

- Marine Cable Grips
- Wind Turbine Cable Grips
- Fibre Optic Cable Grips
- Cable Laying Rollers
- Line Pulling Swivels
- Cable Pulling Heads



**CABLE PULLING HEAD**



Slingco's Pulling Head is designed to be used for subsea cable pull-ins, allowing a messenger line to be attached to the pulling head to guide the cable along the sea floor and up through a J tube for installation to a wind turbine.

| Slingco Part No | Cable diameter |     | Weight |      |
|-----------------|----------------|-----|--------|------|
|                 | in             | mm  | lb     | kg   |
| ZPH15107        | 3.54           | 90  | 117    | 53   |
| ZPH15108        | 3.66           | 93  | 116    | 52.4 |
| ZPH15109        | 3.82           | 97  | 114    | 51.7 |
| ZPH15110        | 4.06           | 103 | 111    | 50.5 |
| ZPH15111        | 4.09           | 104 | 143    | 64.9 |
| ZPH15112        | 4.25           | 108 | 141    | 64   |
| ZPH15113        | 4.57           | 116 | 137    | 62.1 |

**Note:** Part Nos. ZPH15107-ZPH15110 and ZPH15111-ZPH15113 share a common outside geometry, respectively, and are machined internally to fit the required cable diameter. Other sizes to suit array cables up to 7.8 in (197 mm) are also available on request. All Pulling Heads have WLL 15te, MBL 45Te. Sf 3:1 (Safety Factor).

- Ensures no damage or strain during pulling process
- Maintains tension and alignment during seabed cable-laying
- Extremely heavy duty and suitable for large underwater applications

**'V' TYPE LEAD IN CABLE LAYING ROLLERS**

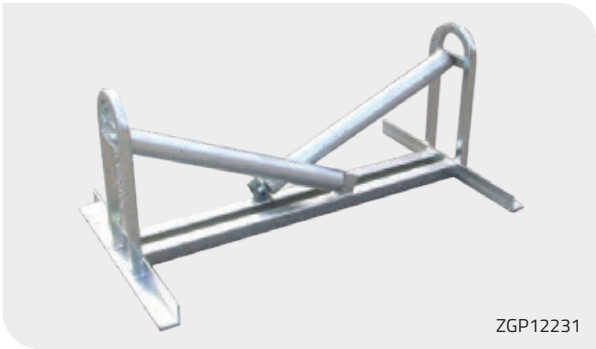

The Slingco 'V' Style Cable Roller leads the cable from the drum into the trench, the design is such that cable is centralized prior to it being fed into the trench. This cable roller can also be used as a Pipe Roller.

| Slingco Part No | Length |     | Width |    | Height |    | Special features                          |
|-----------------|--------|-----|-------|----|--------|----|---|
|                 | in     | mm  | in    | mm | in     | mm |   |
| ZGP12231        | 41.33  | 105 | 23.62 | 60 | 17.32  | 44 | Fixed Shaft for heavy applications        |
| ZGP12230        | 33.46  | 85  | 23.62 | 60 | 17.32  | 44 | Spring Loaded Shafts for easy replacement |
| ZGP12229        | 19.69  | 50  | 15.75 | 40 | 9.84   | 25 | Spring Loaded Shafts for easy replacement |

**QUAD ROLLER (HEAVY DUTY)**



The QR1 quadrant roller can be bolted to floors, beams, trays, racks, or fitted to a free-standing frame. Fitted with a hinged gate, cable can easily be extracted.

The cable roller is suitable for cables up to 6.3in (160mm) diameter with a weight capacity of 881.84lb (400kg)

| Slingco Part No | Length |     | Width |     | Height |     | Special features                     |
|-----------------|--------|-----|-------|-----|--------|-----|--------------------------------------|
|                 | in     | mm  | in    | mm  | in     | mm  |                                      |
| ZGP16204        | 11.81  | 300 | 7.09  | 180 | 14.96  | 380 | Supplied with removable fixing angle |

# IMPORTANT TECHNICAL INFORMATION

## CABLE PULLING GRIPS AND CABLE SUPPORT GRIPS

### ASSESSMENT OF SUITABILITY

There are many factors that must be taken into account when assessing the suitability of a cable grip for a proposed application and trying to calculate a safe working load. These include:

- Size of cable grip in relation to size/shape of gripped object(s)
- Stability of object(s) when gripped
- Grip surface of object(s)
- Resistive force of object(s)
- Anticipated path of movement, including possible obstructions
- Approximate breaking strength of the cable grip
- Condition of cable grip
- Suitability and compatibility of any attachments used
- Environment / operating conditions
- Persons at risk

If you have any questions regarding suitability for any particular application please call the distributor who supplied the cable grip or our in-house Technical Department.

*Please note:* Slingco cable grips must be double steel banded securely before being pulled.

### LATTICE DIMENSIONS

Lattice dimensions shown are as fitted to a nominal diameter of cable and prior 'free length' may be slightly longer than stated.

### APPROXIMATE BREAK LOAD

This is the calculated average based on actual testing done by Slingco. Approximate Break Loads are quoted as a guide only.

### TYPICAL CONFIGURATIONS

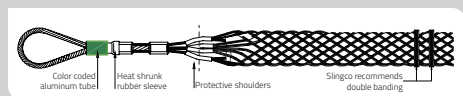

### SAFE WORKING LOAD

Application load is normally calculated to be reduced by at least a factor of 5x the Approximate Break Load. Due to the wide variety of application parameters, the end user must apply a sensible safety factor to suit the safety requirements for the conditions of use.

The Safe Working Load (SWL) of a Slingco cable grip will depend on the Factor of Safety (FOS) applied to the Minimum Breaking Load.

### FACTOR OF SAFETY (FOS)

Where the operational risk is considered to be normal, it is recommended that a FOS of 5 be applied, for a high risk operation a FOS of at least 10 should be considered. It is impossible to catalog or guarantee a safety factor that will apply for all applications.

Approximate Break Loads stated on any certification, the recommended Factors of Safety, and any implied or stated fitness for purpose, are all only applicable when the cable grip is as new and unused.

A 20% variance in break loads must be allowed for when selecting a cable grip; a suitable swivel must be used if there is 'twist' in the cable.

Pulling devices should only be attached via the pulling eye.

Torsional stress must be dealt with when using grips for line pulls and wire splices. When twisting forces are present use a swivel that rotates under load to release torsional stress.

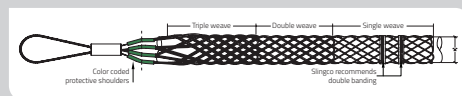

## Cable Grip Safety Information

- Ensure that the cable grip mesh fits conductor correctly.
- Ensure that the conductor fits up to the mid-point of the protective shoulder.
- Band the ends of the cable grip when attaching the conductor. We recommend between 1 1/4" and 2 1/2" from the end of the cable grips.
- Never modify or attempt to repair any grip.
- Ensure proper maintenance of the cable grip. If in doubt call 888-685-9478.
- Check the condition of the cable grip, and that it is the correct size for the intended application - do not exceed the rated capacity.
- Grips that are worn, bent or otherwise damaged should not be used.
- Grips are only to be used for temporary installations
- Pulling devices should only be attached via the pulling eye. It is NOT recommended that grips or swivels be run over tensioners while under load.
- Cable grips must only be fitted and used by trained competent person(s).



SLINGCO CABLE GRIPS MUST NOT BE USED TO THEIR APPROXIMATE BREAKING STRENGTH. A SENSIBLE SAFETY FACTOR MUST ALWAYS BE USED. IF IN DOUBT CONTACT THE MANUFACTURER OR THE DISTRIBUTOR THAT SUPPLIED THE GRIP!

If you have any questions regarding suitability for any particular application please call 888-685-9478



## SINGLE AND DOUBLE EYE CABLE GRIP INSTRUCTIONS

**PLEASE NOTE:** The condition of the cable grip should always be checked prior to use. The correct size of grip should always be used for the intended application. The rated capacity of the grip should never be exceeded. Grips that are worn, bent or otherwise damaged should not be used.



1 Select the correct grip for the diameter of the conductor.

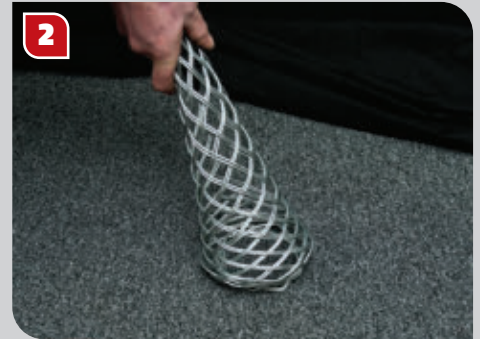

2 Prior to use, the lattice at the end of the grip needs to be widened. This can be easily achieved by pressing the end of the grip against a hard surface, which causes the lattice to expand.



3 The grip should then be placed over the end of the conductor...



4 ...and pushed over the conductor.

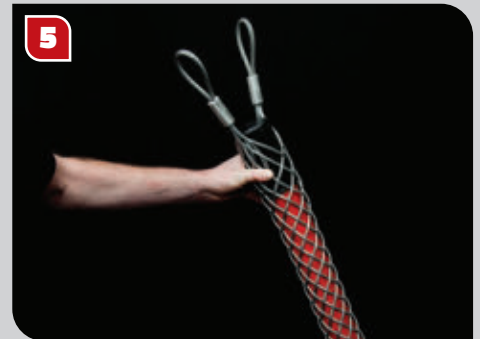

5 The grip then needs to be pushed along so that all the lattice is in contact with the conductor.



6 Once the cable grip is in place on the conductor, two bands should be fitted to the end of the grip (as shown). We recommend between 1 1/4" (30mm) and 2 1/4" (55mm) away from the end of the cable grip.



7 Tape should then be wound around the end of the cable grip furthest away from the eye ends.

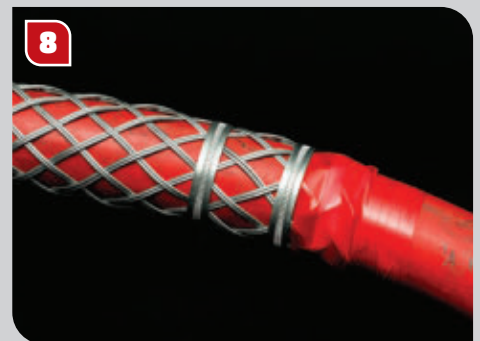

8 This will prevent the cable grip from snagging when in use.

 **888 685 9478**

 [sales@slingcoamerica.com](mailto:sales@slingcoamerica.com)

 [slingco.com](http://slingco.com)



**Slingco America, Inc.**, 3100 Jonquil Drive SE, Smyrna, GA 30080, USA · TOLL FREE: 888 685 9478 · [sales@slingcoamerica.com](mailto:sales@slingcoamerica.com)

Slingco makes no warranty, express or implied, with respect to these products nor with respect to their specifications. In no event shall Slingco be liable for any direct, indirect, punitive, incidental, special consequential damages to property or life, whatsoever, arising out of or connected with the use or misuse of these products. These products are intended for use by qualified professionals having adequate knowledge of their proper use. *January 2026 - v1.0*