

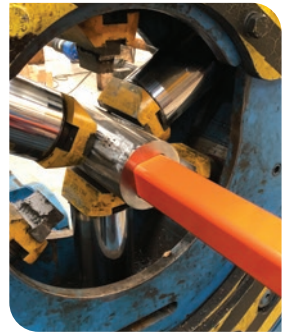

10K DRIVE WRENCH
ASSEMBLY
EFFICIENT INSTALLATION
OF SCREW ANCHORS



10K DRIVE WRENCH ASSEMBLY FOR EFFICIENT INSTALLATION OF SCREW ANCHORS

Drive Wrench System for installation of screw anchors. Component and options include:

- Orange Drive Wrench (#SAE09639)
- Yellow Drive Wrench (#SAE08666)
- Square Shank Anchor Tool (#SAE11132)
- Drive Wrench Lock (#SAE10425)
- Square Drive Head Adapter (#SAE14309)
- 2.625 in (66.7 mm) Hex Kelly Bar Adapter (#SAE10427)
- 1.5 in (38.1 mm) Square Shank Bolted Assembly (#SAE13513)

Slingco's 10k Drive Wrench Assembly is a tool system for the installation of screw anchors.

Designed to connect the square anchor of a drive motor or screw anchor to the hexagonal Kelly Bar of a bucket truck. System options include Drive Wrenches to suit different sized anchor rods; a Drive Wrench lock; two Kelly Bar Adapters to fit the hex drive bar's dimensions (2.5 in and 2.625 in) and one Square Head Kelly Bar Adapter to suit 3 in Square Drive Bar.

The Drive Wrench Lock attaches to the Kelly Bar Adapter and makes the installation of the Anchor Rod much easier. The three position rings of the lock assembly ensure easy capture of the Drive Wrench and Anchor Rod, holding them securely while under torque and releasing them when needed.

The Drive Wrenches are designed to allow Anchor Rods to telescope inside, and secure to, the Drive Wrench Lock. The Drive Wrench transfers the torque from the Drive motor to the Screw Anchor, and are rated to 10,000 ft-lb.

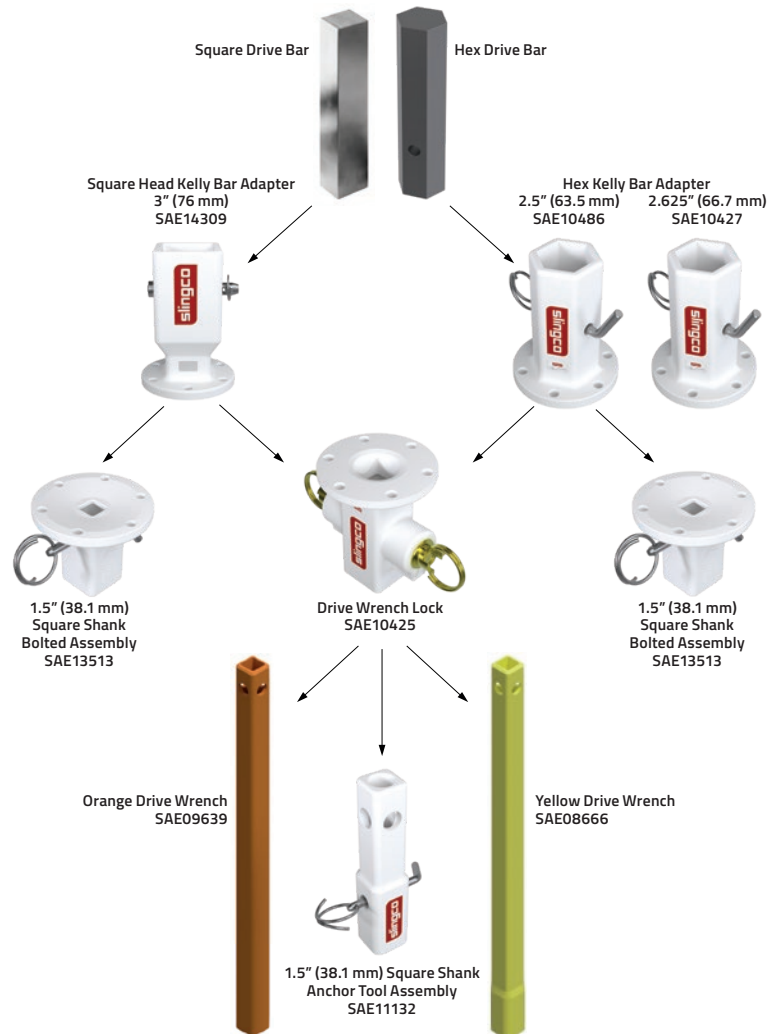

HEX KELLY BAR ADAPTERS



Slingco's Hex Kelly Bar Adapters are a key component in the Drive Wrench Assembly. The adapters are used to connect the Drive Wrench Lock Assembly to the Kelly Bar of the bucket truck. There are two versions available which fit the most common drive bar dimensions.

Slingco Part No.	Kelly Bar Shape	Adapter dimensions						Weight each	
		X		Y		Z		lb	kg
		in	mm	in	mm	in	mm		
SAE10486	HEX	2.5	63.5	4.25	108	8.25	210	16.3	7.39
SAE10427	HEX	2.625	66.7	4.25	108	8.25	210	16.7	7.57

SQUARE HEAD ADAPTER

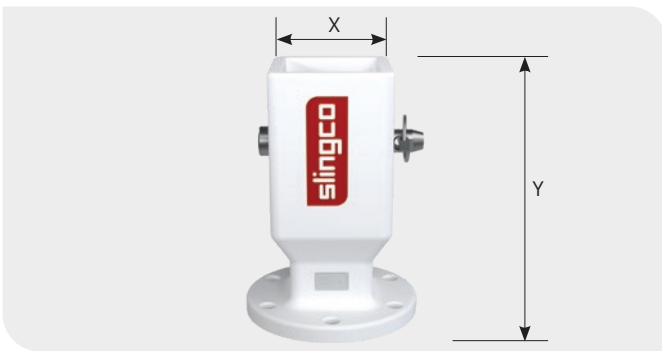

Slingco's Square Head Kelly Bar Adapters are a key component in the Drive Wrench Assembly. The adapters are used to connect the Drive Wrench Lock Assembly to the Kelly Bar of the bucket truck.

Slingco Part No.	Kelly Bar Shape	Description	Adapter dimensions				Weight	
			X		Y		lb	kg
			in	mm	in	mm		
SAE14309	SQU	76 x 76 mm Square Head Adapter	3	76	9.4	240	16.5	7.5

DRIVE WRENCH LOCK ASSEMBLY

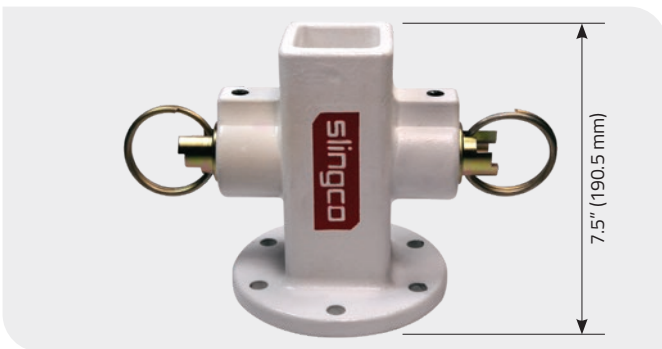

Slingco's Drive Wrench Lock Assembly attaches to the adapter and makes the installation of the anchor rod much easier. The three-position rings allow for easy capture of the Drive Wrench and the anchor rod, holding them securely while under torque, and releasing each when needed.

Slingco Part No.	Description	Weight	
		lb	kg
SAE10425	Drive Lock Assembly	18.4	8.35
SAE13513	1-1/2" (38.1 mm) Square Shank Bolted Assembly		

DRIVE WRENCHES



Slingco's Drive Wrenches are designed to allow anchor rods to telescope inside them, and securing to the Drive Wrench Lock Assembly. The Drive Wrench transfers the torque from the drive motor to the screw anchor.

Rated to 10,000 ft-lb of torque, Slingco's Drive Wrenches are tough and can handle anchor installs in tough environments.

Slingco Part No.	Description	Hub Size		Shaft Size	
		in	mm	in	mm
SAE09639	10,000ft-lb Orange Drive Wrench	2.25	57	1.375	35
SAE08666	10,000ft-lb Yellow Drive Wrench	2.5	63.5	1.5	38
SAE11132	1-1/2" (38.1 mm) Square Shank Anchor Tool Assembly				

57 lb (28.85 kg) is the weight of each Drive Wrench

FOR ANY ENQUIRIES CALL TODAY ON
+61 3 8840 6556



Slingco Australia Pty. Ltd.
Tel: +61 3 8840 6556 · sales@slingcoaustralia.com.au

slingcoaustralia.com.au

This document is for marketing purposes only. The information contained herein is presented as general information and no representation or warranty is expressly or impliedly given as to its accuracy, completeness or correctness. It does not constitute part of a legal offer or contract. For technical specifications, please contact Slingco Australia Pty. Ltd. July 2023 - v1.1